

RX-CAN-2G4 CANBUS RADIO RECEIVER**DESCRIPTION**

Compact radio receiver / transceiver with CANbus interface. For use with Tecnord single-hand or multifunction Radio Transmitters.

OPERATION

RX-CAN radio transceiver is designed to allow radio remote operation of machines equipped with a CAN-based control system. Its compact and rugged design allows easy installation, even in weather-exposed locations on the machine. Standard communication protocols include CANopen and J1939.

Customized protocols are available for OEMs. Each Tecnord Radio is produced with a unique identifier (System ID). In case of lost Transmitter, a simple self-learning procedure allows to match a new spare transmitter. The transmission technology used allows high immunity to interference and long operating range. Co-existence between multiple units is also allowed. A unique code allows the RX-CAN transceiver controller to operate only with its coupled radio transmitter.

FEATURES

- Supply line is protected against reversed polarity and overvoltage.
- CANbus line is protected against short circuits to GND and supply.
- Microprocessor based.
- Vibration and shock resistant.
- Easy installation with 4 screws (option: magnet).
- CE, FCC, IC certifications available
- Electro Magnetic Compatibility (EMC): EN 61000-6-2 (Immunity)
EN 61000-6-3 (Emissions)

SPECIFICATIONS

| | |
|---------------------------|----------------------------------------------------------------|
| Operating voltage: | 6.5 ÷ 30 VDC |
| Max current consumption: | 200 mA |
| Operating temperature: | -40 ÷ +85°C |
| Environmental protection: | IP 68 |
| Operating Frequency Band: | 2402 ÷ 2480 MHz |
| Transmission type: | BT 2.1 + EDR |
| Antenna: | Built-in (internal) |
| Diagnostics: | 1 LED for the radio link status 1 LED for the CANbus status |
| CANbus physical layer: | ISO 11898 |
| CANbus protocol: | J1939 (standard) CANopen (option) |
| Connector type: | Deutsch DT04-4P |

APPLICATIONS

- 12 VDC and 24 VDC systems.
- Remote control of aerial platforms, telehandlers, agricultural machines and lift equipment equipped with CANbus systems.

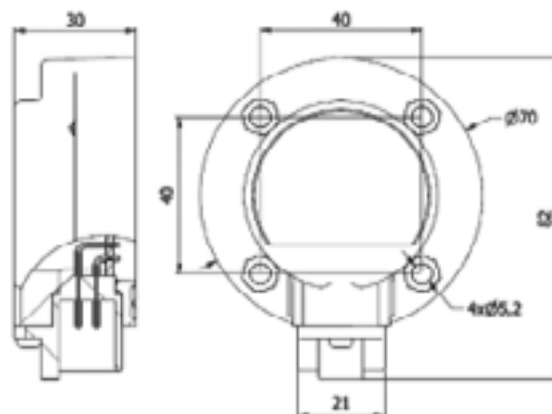
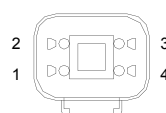
**DIMENSIONS****CONNECTIONS****Deutsch DT04-4P**

- 1 +V (POWER SUPPLY)
- 2 CAN - H
- 3 CAN - L
- 4 -V (POWER SUPPLY - GND)

RX ORDERING INFORMATION: see page RC3

WARNING: the specifications/application data shown in our catalogs and data sheets are intended only as a general guide for the product described (herein). Any specific application should not be undertaken without independent study, evaluation, and testing for suitability.