

**“W” TYPE COIL**

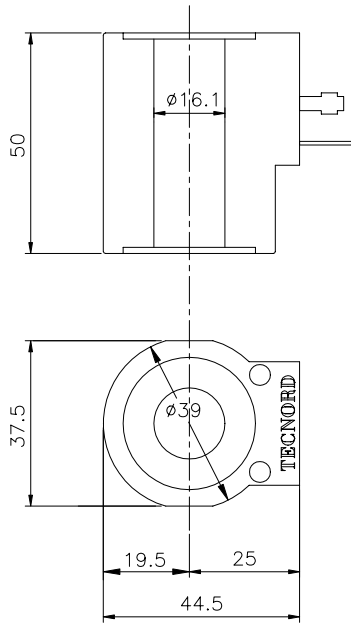

**DESCRIPTION**

5/8 inch (16 mm) I.D. Coil.  
Color identification: black

**FEATURES**

One piece encapsulated design that is:

- Immersion proof
- No external metal shell
- Internal arc suppression diode available on request

**COIL SPECIFICATION**

Wattage	24 Watts Nominal
Duty Rating	Continuous Duty $\pm 10\%$ rated voltage at 120°F (49°C) ambient
Min Current for Actuation	80% of rated current at room temperature
Magnet Wire Class	H (200°C)
Heat insulation Class	H (180°C)
Ambient Temperature Range	-30° to 60°C
Protection degree	Up to IP 65 (with connector and suitable seals)
Encapsulation Material	Glass filled polyester, resistant to moisture, caustic solutions, fungus and vibration

**WDL**

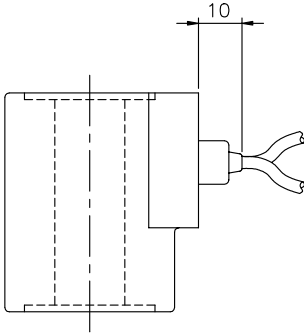

**WHC**

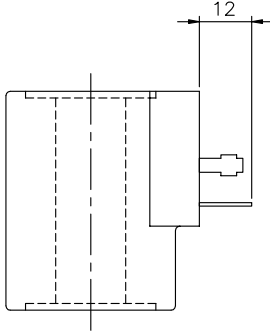

**WDI**

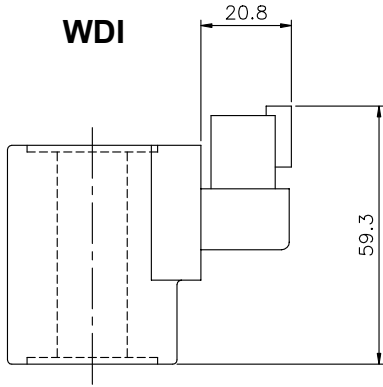

**ORDERING INFORMATION**

<b>W</b>	<b>-</b>	<b>-</b>	<b>-</b>
<b>TERMINATIONS</b>			
Double Lead	<b>DL</b>	<b>12</b>	
DIN 43650 (Hirschmann)	<b>HC</b>	<b>24</b>	
Deutsch - Integral DT04-2P	<b>DI</b>	<b>22</b>	

**VOLTAGE**

12 VDC / 2.03 A  
24 VDC / 1.01 A  
220 VAC / rectified 0.06 A  
*without internal rectifier (for HC termination only)  
supply voltage must be externally rectified*

Approximate Coil Weight: .69 lbs (.31 kg)